

PRODUCT SPECIFICATION SHEET



LINEARE 1800 TOWER UNIT

Model: CMV-10-2-TWR
Size: 350 x 350 x 1800
Material: Plywood, MDF
Installation: Wall hung
Finish: Matte thermofoil

Internal cabinet colour: Grey
Warranty: 5 years
Hinges: Hettich soft close
Weight: 26.5Kg

Colour Range:

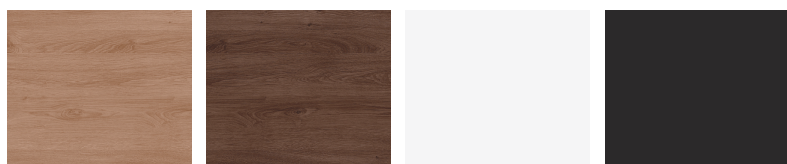

Devon Oak

Walnut

Matte White

Matte Black

Profile options:



Axel

Loft

Coastal

Orchard

Pillar

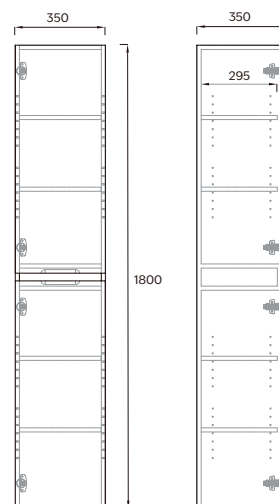

Note: All measurements shown are in millimetres. Sizes are nominal.

Distributed by:

CODE
INTERIORS

In accordance with our continuous product development, Code interiors sizes and specifications outlined in these specifications are subject to change without notice. Information detailed in this document represents the actual product available at the time of printing this sheet. For the latest version of this technical sheet please visit www.codeinteriors.co.nz or contact your nearest stockist to confirm any questions prior to purchase.

sales@codeinteriors.co.nz | 09 973 4066 | www.codeinteriors.co.nz